

drive-through

building area - 4,000 sq. ft.

site area developed - 42,100 sq. ft.

impervious area - 30,800 sq. ft.

parking spaces - 46

- natural gas
- ▨ overhead electric
- ⊙ power pole
- water
- ▩ sanitary sewer



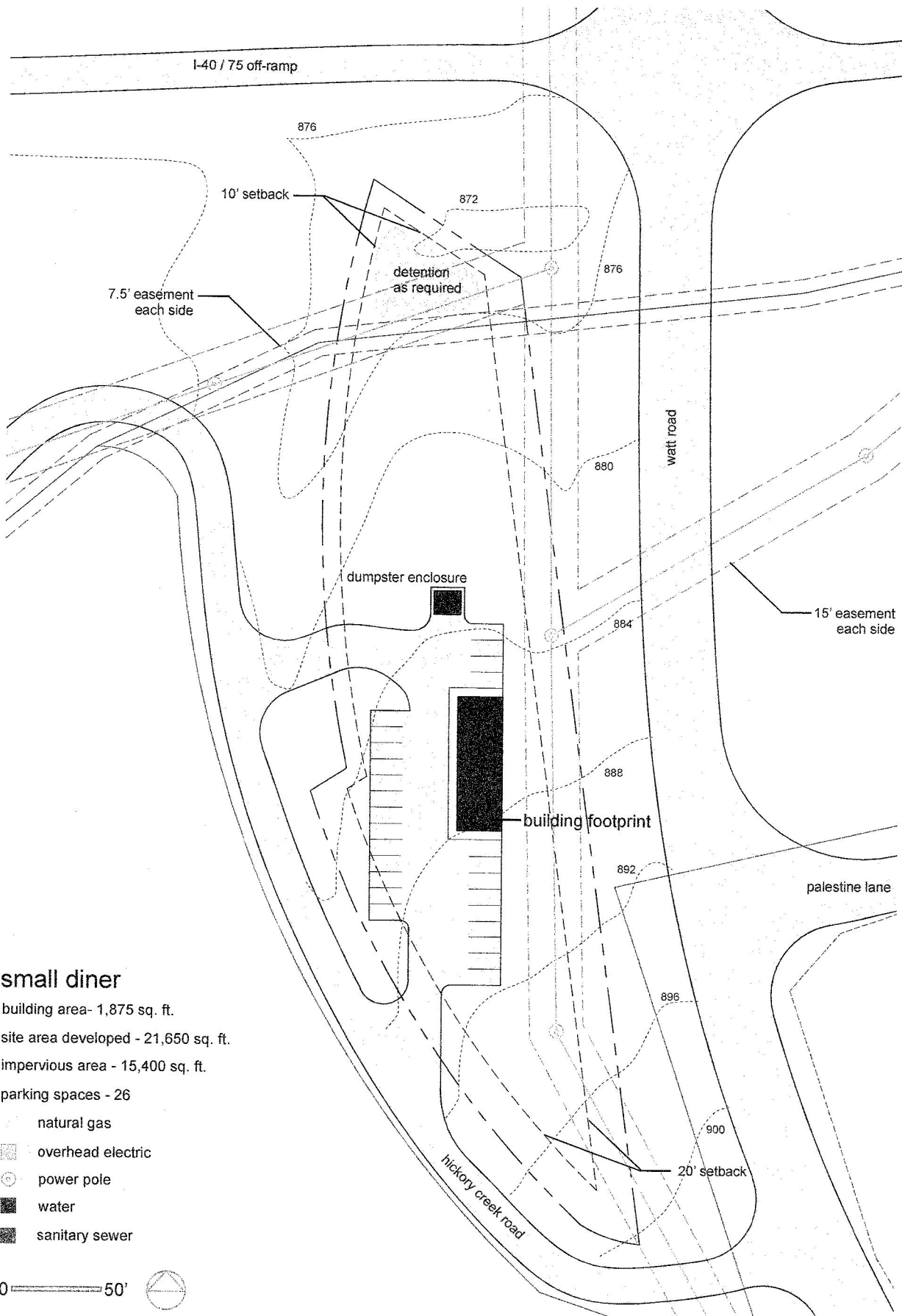

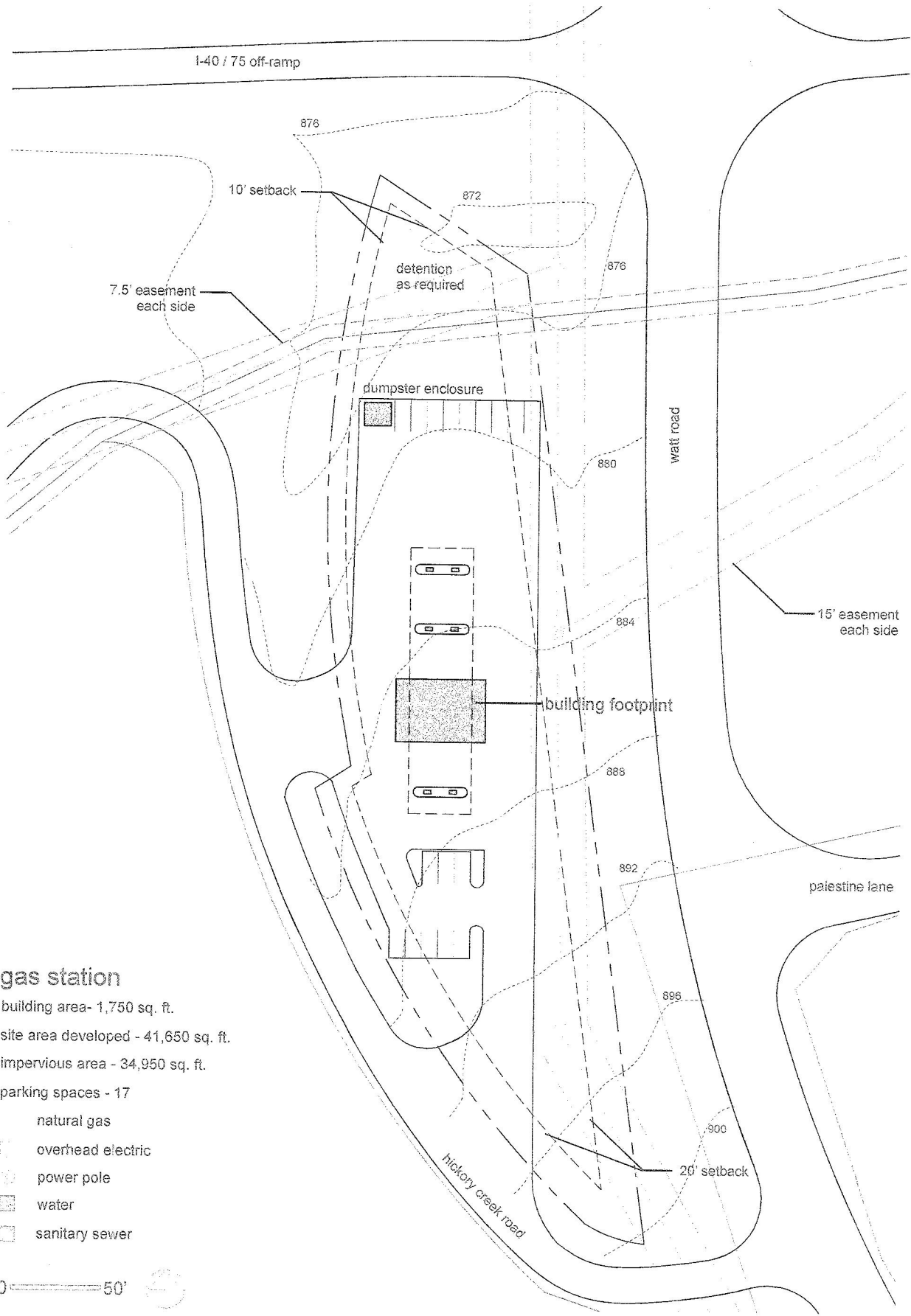

gas station

building area - 1,750 sq. ft.
 site area developed - 41,650 sq. ft.
 impervious area - 34,950 sq. ft.
 parking spaces - 17

- natural gas
- overhead electric
- power pole
- water
- sanitary sewer

0 ————— 50'